



IKON Masterkeyed Cylinders

Cylinder & Turn 25mm Diameter



Z534 / KNF91

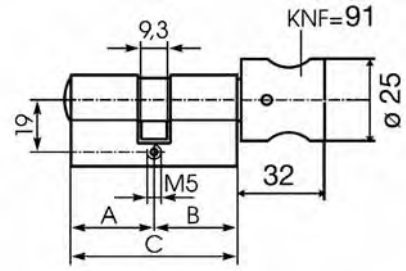

Dimensions

Double Cylinder



Z531

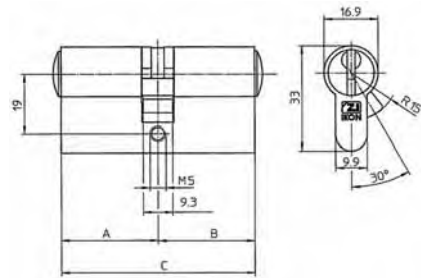

Dimensions

Single Cylinder



Z532

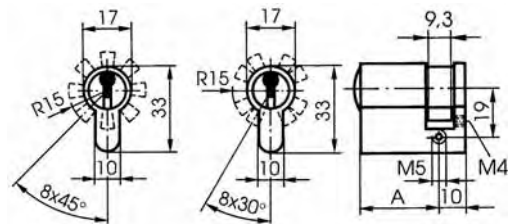

Dimensions

Cylinder & Turn 42mm Diameter



ZK534 / KNF1

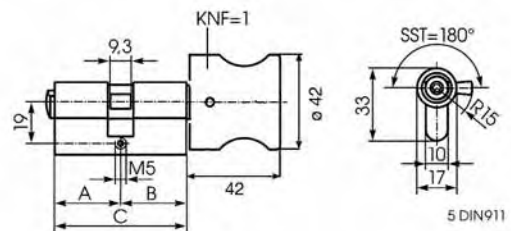

Dimensions

Cylinder Indicator & Turn Red & Green



1534/KNF91

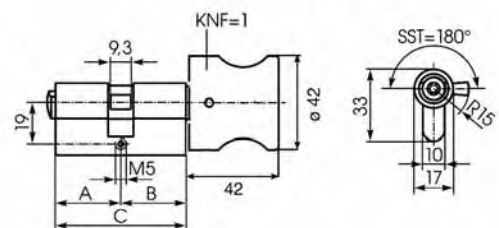

Dimensions



IKON Masterkeyed Cylinders

Thumbturn cylinders .534,KNF=91

- Brass cylinder, mat nickel-plated
- Number of pin tumblers and basic cylinder length relative to respective system
- Core pins made of special wear-resistant bronze
- Convex cylinder core with reinforced key way
- Sintered metal key way, depending on system
- Anti-drilling protection, depending on profile and system
- Former thumbturn shape 9 of BAB

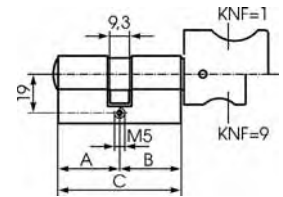

Technical Requirements - DIN EN 1303 and DIN 18 252

Comparison of class divisions of profile cylinders in accordance with DIN EN 1303 and DIN 18 252/1999

Standardising at European level influences national standards. The launch of DIN EN 1303 (locking cylinders for locks) in May 1998 led to the withdrawal of the national DIN 18 252 and DIN V 18 254, both issued in 1991.

Aspects not covered by DIN EN 1303 are summarised in DIN 18 252/1999. Performance characteristics are comparable.

New, however, is that DIN EN 1303 and Din 18525/1999 also take other high-quality tumbler systems differing from the classical pin tumbler system into consideration.

The following tables show an overview of locking cylinder class divisions complying with DIN EN 1303 and DIN 18525/1999. The manufacturer can divide the locking cylinders into categories meeting DIN 18252 P2 and P3.

Locking cylinders carrying the "DIN tested" symbol have been assessed, categorized and certified by an official testing institute.

Examples:

SK6, slanted with AB+KS

Utility class (position 1):	1
Durability class (position 2):	6
Fire resistance (position 4):	1
Corrosion resistance (position 6):	1
Locking security (position 7):	5

Security class complying with DIN 18 252: P3 and DIN certificate available.

*"P3/optional" means: Resistance class 3 profile cylinders complying with DIN 18525/1999 are optionally available with DIN approval



IKON Masterkeyed Cylinders

Thumbturn / Single Cylinder



1535 / KNF91

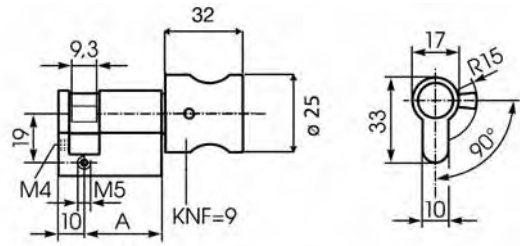

Dimensions

Padlock



Z315

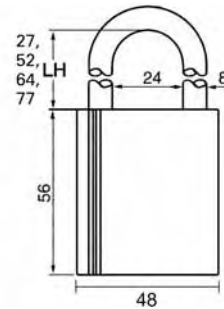

Dimensions

Rim Cylinder



Z050

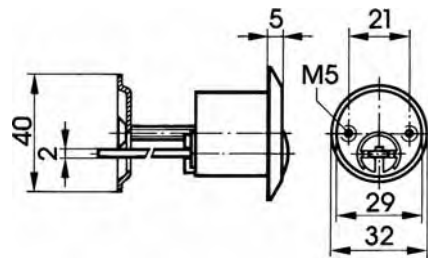

Dimensions

Cylinder Fixing Screw

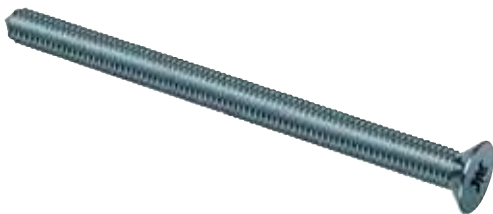

1150

Fixing Screws / Connecting Rod



1438 / 1521

Backplate / Shim



1154 / 1156

Building Key Kit



8160