

# Product Spec Sheet

Name: Falling Hinges 102 x 76 x 3mm

Code: FB76



## Specification

### Usage:

Residential toilet doors  
Door always open  
Max door weight 45kg

### Material:

Stainless steel

### Finishes:

SSS

### Fixings:

Wood screws

## Dimensional Drawing:

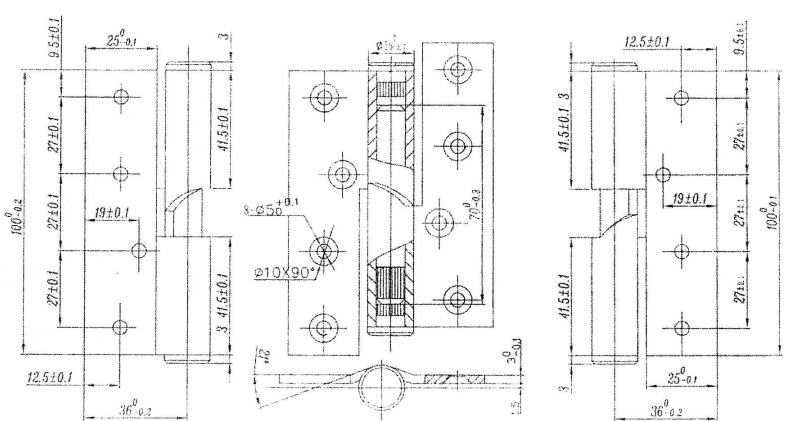

## Note: Handing

**Right hand**  
anti clockwise closing

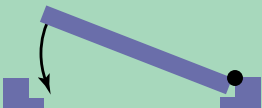

**Left hand**  
clockwise closing



## Declaration of Performance:

N/A